

## ES SAE Straight flange adapter

SAE Flange / Socket weld tube end  
(ISO 6162-1/-2)

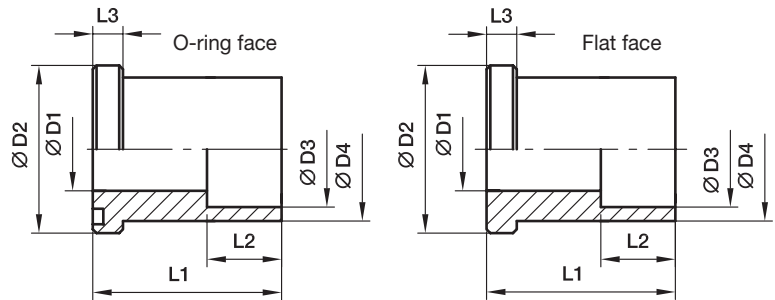

### 6000 PSI Series

Nom. flange size		⌀								Weight (steel) kg/piece	O-ring face Order code*	Flat face Order code*	PN (bar) <sup>1)</sup>	
SAE (in.)	ISO (DN)		max.	D1	D2	D3	D4	L1	L2				L3	S
1/2	13	16.0	11.0	31.8	16.5	24.0	35	13	7.7	0.26	<b>ES62/16.5</b>	<b>ESG62/16.5</b>	420	420
1/2	13	17.3	11.0	31.8	17.6	24.0	35	13	7.7	0.24	<b>ES62/17.6</b>	<b>ESG62/17.6</b>	420	420
3/4	13	20.0	15.0	41.3	20.5	31.8	40	13	8.7	0.37	<b>ES63/20.5</b>	<b>ESG63/20.5</b>	420	420
3/4	19	21.3	15.0	41.3	21.7	31.8	40	13	8.7	0.33	<b>ES63/21.7</b>	<b>ESG63/21.7</b>	420	420
1	25	25.0	20.0	47.6	25.5	38.0	45	13	9.5	0.48	<b>ES64/25.5</b>	<b>ESG64/25.5</b>	420	420
1	25	26.9	20.0	47.6	27.3	38.0	45	13	9.5	0.43	<b>ES64/27.3</b>	<b>ESG64/27.3</b>	420	420
1 1/4	32	30.0	24.0	54.0	30.5	44.0	50	16	10.3	0.68	<b>ES65/30.5</b>	<b>ESG65/30.5</b>	420	420
1 1/4	32	32.0	24.0	54.0	32.5	44.0	50	16	10.3	0.65	<b>ES65/32.5</b>	<b>ESG65/32.5</b>	420	420
1 1/4	32	33.7	24.0	54.0	34.2	44.0	50	16	10.3	0.64	<b>ES65/34.2</b>	<b>ESG65/34.2</b>	420	420
1 1/2	38	38.0	31.0	63.5	38.5	51.0	55	18	12.5	0.92	<b>ES66/38.5</b>	<b>ESG66/38.5</b>	420	420
1 1/2	38	40.0	31.0	63.5	40.7	51.0	55	18	12.5	0.88	<b>ES66/40.7</b>	<b>ESG66/40.7</b>	420	420
1 1/2	38	42.4	31.0	63.5	42.8	51.0	55	18	12.5	0.85	<b>ES66/42.8</b>	<b>ESG66/42.8</b>	420	420
2	51	48.3	38.0	79.4	49.0	67.0	65	20	12.5	1.25	<b>ES68/49</b>	<b>ESG68/49</b>	420	420
2	51	50.0	38.0	79.4	50.7	67.0	65	20	12.5	1.21	<b>ES68/50.7</b>	<b>ESG68/50.7</b>	420	420

<sup>1)</sup>Pressure shown = Item deliverable

PN (bar) = PN (MPa)  
10

The pressures given here are the maximum allowable for the flange fittings. If the pipe or tube used has a lower pressure rating, then the welded assembly rating will be the lower one, assuming the weld is adequately strong.



\*Please add the **suffixes** below according to the material/surface required.

Order code suffixes					
Material	Suffix surface and material	Example only flange adapter	Example incl. splitflanges, metr. screws and O-ring	Example incl. splitflanges, UNC screws and O-ring	Standard sealing material (no additional suffix needed)
Steel, oil dipped	S	ES62/16.5S	ES62/16.5SM	ES62/16.5SU	NBR
Stainless steel	SS	ES62/16.5SS	ES62/16.5SSM	-	VIT