

1CE56 – 24° Sealing Cone / O-Ring 45° Elbow Light Series – Metric Swivel Nut ISO 12151-2

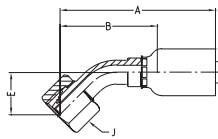

56 Series

Part No. #	DN size mm inch				Connection Type		A mm	B mm	E mm	J mm
	size	mm	inch	Thread Size	Tube OD					
1CE56-6-3	5	-03	4.8	3/16	M12x1.5	6	58	40	17	14
1CE56-8-4	6	-04	6.4	1/4	M14x1.5	8	65	40	18	17
1CE56-10-4	6	-04	6.4	1/4	M16x1.5	10	64	40	17	19
1CE56-10-5	8	-05	7.9	5/16	M16x1.5	10	66	40	18	19
1CE56-10-6	10	-06	9.5	3/8	M16x1.5	10	68	43	19	19
1CE56-12-6	10	-06	9.5	3/8	M18x1.5	12	69	44	19	22
1CE56-15-8	12	-08	12.7	1/2	M22x1.5	15	77	49	21	27
1CE56-18-12	20	-12	19.0	3/4	M26x1.5	18	95	61	25	32
1CE56-22-12	20	-12	19.0	3/4	M30x2	22	96	62	26	36

Material: Steel, surface protection according to DIN 50 961 Fe/Zn, special materials available upon request

1CF56 – Sealing Cone / O-Ring 90° Elbow Light Series – Metric Swivel Nut ISO 12151-2

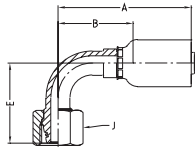

56 Series

Part No. #	DN size mm inch				Connection Type		A mm	B mm	E mm	J mm
	size	mm	inch	Thread Size	Tube OD					
1CF56-6-3	5	-03	4.8	3/16	M12x1.5	6	46	28	30	14
1CF56-8-4	6	-04	6.4	1/6	M14x1.5	8	53	29	32	17
1CF56-10-4	6	-04	6.4	1/6	M16x1.5	10	53	29	31	19
1CF56-10-5	8	-05	7.9	5/16	M16x1.5	10	55	30	32	19
1CF56-12-5	8	-05	7.9	5/16	M18x1.5	12	56	30	33	22
1CF56-10-6	10	-06	9.5	3/8	M16x1.5	10	58	33	35	19
1CF56-12-6	10	-06	9.5	3/8	M18x1.5	12	58	36	33	22
1CF56-15-8	12	-08	12.7	1/2	M22x1.5	15	68	40	41	27
1CF56-18-12	20	-12	19.0	3/4	M26x1.5	18	87	54	53	32
1CF56-22-12	20	-12	19.0	3/4	M30x2	22	87	54	65	36
1CF56-28-16	25	-16	25.4	1	M36x2	28	115	67	69	41

Material: Steel, surface protection according to DIN 50 961 Fe/Zn, special materials available upon request

